

iQ300, French Door Bottom freezer, multi door, 183 x 90.5 cm, BlackSteel, Total noFrost KF96NAXEA



French door with cross door and hyperFresh <0°C> freshness system: perfect storage conditions for fish and meat as well as fruits and vegetables

- ✓ bigCapacity: More storage space for your groceries.
- ✓ Total noFrost: Never defrost your freezer again and bid farewell to water drops on the fridge backwall.
- ✓ Metal backwall with multiAirflow: Evenly cooled food and drinks on all levels.
- ✓ hyperFresh <0°C>: More space for fruit and vegetables. A cold climate for fish and meat.
- ✓ LED light: Even lighting throughout the interior allows for easy visibility of all items.

Features

Technical Data

Energy Efficiency Class (Regulation (EU) 2017/1369) ¹ :	E
Average annual energy consumption in kilowatt hour per year (kWh/a) ² :	333 kWh/annum
Sum of volume of frozen compartments:	200 l
Sum of volume of chill compartments:	405 l
Airborne acoustical noise emissions :	38 dB(A) re 1pW
Airborne acoustical noise emission class:	C
Design:	Free-standing
Number of compressors:	1
Number of independent cooling systems:	1
Width of the appliance:	905 mm
Height:	1830 mm
Depth:	731 mm
Net weight:	111.6 kg
Door panel options:	Not possible
Door hinge:	left and right
Number of Adjustable Shelves in fridge compartment:	3
Shelves for Bottles:	No
Frost free system:	Fridge and freezer
Interior ventilator:	Yes
Reversible Door Hinge:	No
Length electrical supply cord:	240 cm
Noise level:	38 dB(A) re 1pW
Multi-Flow Air Tower:	Yes
Fast cooling switch:	Yes
Fast freezing function:	Yes
Temperature Controlled Drawer:	No
Humidity Control Drawer:	No
Number of Door Bins - Refrigerator:	4
Door bin adjustability - Refrigerator:	Yes
Tilt-out door bins in fridge:	Yes
Gallon wide door bins:	Yes
Number of Gallon storage:	2
Motorized Shelf:	No
Material of the shelves:	Safety glass
Door opened indicator freezer:	Yes
Automatic motor-driven ice-maker:	No
Fuse protection:	10 A
Voltage:	220-240 V
Frequency:	50-60 Hz
Storage Period in Event of Power Failure (h):	15 h
Door panel options:	Not possible
Noise level:	38 dB(A) re 1pW
ENERGY STAR® certified:	No
Plug type:	Gardy plug w/ earthing
Required cutout/niche size for installation (in):	x

¹ Scale of Energy Efficiency Classes from A to G

² Based on the results of the standard 24-hour test. Actual consumption depends on usage/position of the appliance.

Dimensions of the packed product: 74.99 x 39.29 x 30.70
Net weight: 246.000 lbs
Gross weight: 284.000 lbs



iQ300, French Door Bottom freezer, multi door, 183 x 90.5 cm, BlackSteel, Total noFrost KF96NAXEA

Features

Performance and consumption

- Energy Class: E
- Total Volume: 605 l
- Net Fridge Volume : 405 l
- Net Freezer Volume : 200 l
- Freezing capacity 24h: 13 kg
- Annual Energy Consumption: 333 kWh/a
- Climate Class: SN-T
- Fast Freeze Facility
- Noise Level : 38 dB , C Class

Design and Styling

- Doors Brushed black steel anti-fingerprint, side panels cast iron
- Classic door , Door Brushed black steel anti-fingerprint, side panels cast iron
- LED interior light in fridge section
- Metal backwall with multi airflow
- Interior with metal applications

Convenience & Safety

- Total noFrost - frost-free freezer and no condensation in fridge
- Wi-Fi
- 7 segment electronic control
- Super Cooling: automatic deactivation
- Automatic defrost in fridge section
- Acoustic warning system, Optical warning system Door open
- Acoustic Warning System, Warning System by temperature increase

Fridge Compartment

- Multi Airflow-System
- 2 door bin(s) high, 2 door bin(s) small
- Bottle storage: none/0
- Dairy compartment

Freshness System

- 1 hyperFresh $\pm 0^{\circ}\text{C}$ box - fish and meat stay fresh for longer.
- 1 hyperFresh box with adjustable humidity on wheels - keeps fruit and vegetables fresh for longer.

Freezer

- 6 transparent freezer drawers
- Ice cube tray
- Without Illumination in freezer section

Dimensions

- Appliance Dimensions (H x W x D): 183 cm x 90.5 cm x 73.1 cm

Technical Information

- 4 wheels for easier transport, 3 of them height adjustable.
- Nominal voltage: 220 - 240 V

Accessories

- ice cube tray
- ice cube tray

Country Specific Options

- Based on the results of the standard 24-hour test. Actual consumption depends on usage/position of the appliance.
- To achieve the declared energy consumption, the attached distanceholders have to be used. As a result, the appliance depth increases by about 3.5 cm. The appliance used without the distance holder is fully functional, but has a slightly higher energy consumption.
- Net 4* compartment volume : 200 l
- Acoustic Warning System
- 2 door bin(s) high
- Illumination: LED interior light
- Energy Efficiency Class EEK-IL 2004: A
- Energy consumption: 472 kWh
- Net capacity: 371 l
- Capacity **** No Frost Freezer: 170 l
- noFrost
- Text for Energy Rate

iQ300, French Door Bottom freezer, multi door, 183 x 90.5 cm, BlackSteel, Total noFrost KF96NAXEA

Dimensioned drawings

Measurements in mm

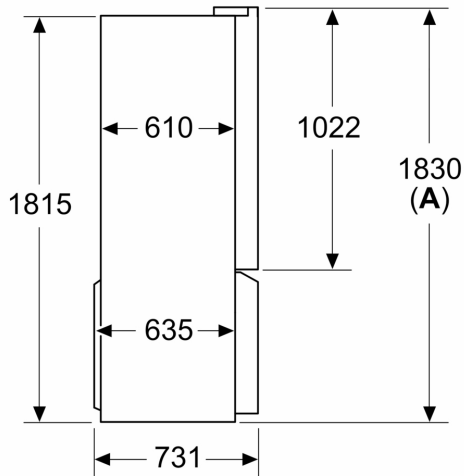

A: Front is adjustable 1830–1847 mm, with front levelling feet fully extended

Measurements in mm

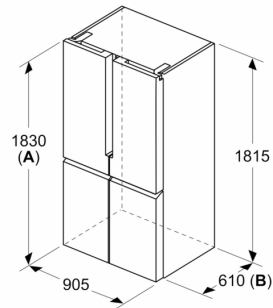

A: Front is adjustable 1830–1847 mm, with front levelling feet fully extended

B: Add 25 mm for fixed spacers on back

Measurements in mm

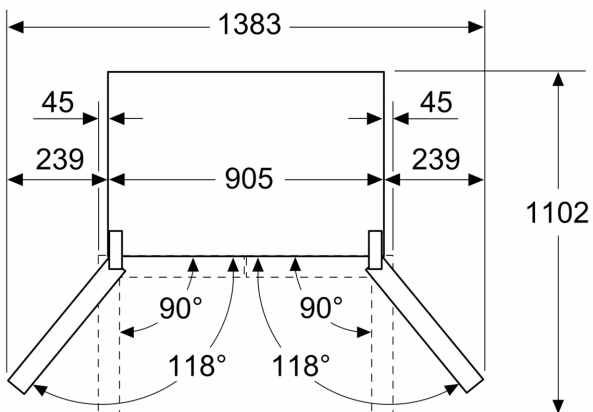

Measurements in mm

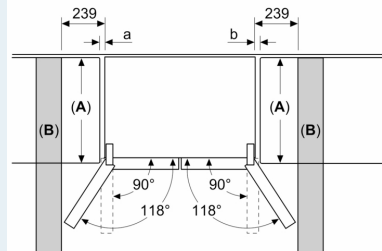

A	a	b
≤ 600	0	0
600 < A ≤ 650	45	45
650 < A ≤ 700	60	60
> 700	239	239

A: Kitchen cabinet or worktop depth

B: Wall
Drawers can be pulled and taken out with door open to 90°